

FILED
GREENVILLE CO. S. C.
AUG 15 9 38 AM '78
DONNIE S. TANKERSLEY
R.M.C.

MACK D. & RUBY L. JENKINS

CONWAY GRACE

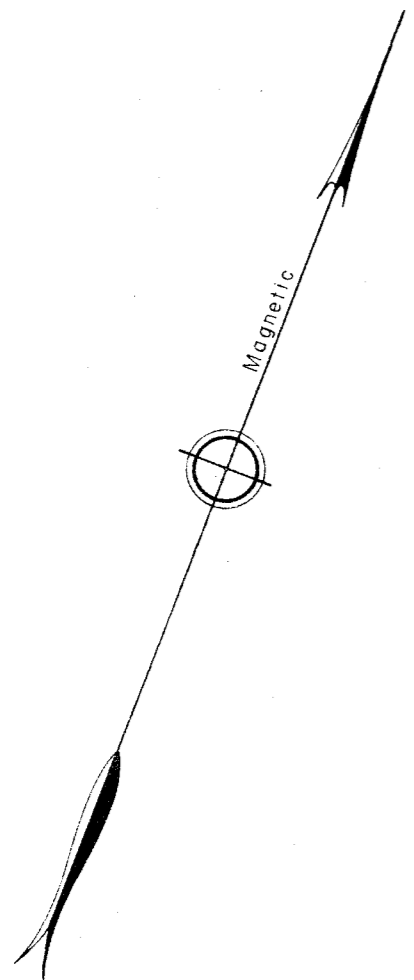

BUNCOMBE ROAD

As per Commissioner of Public Works
this property can be served with
Sanitary Sewer & City Water.

MELVALE REALTY CORPORATION

0.406 Acres
17,685 Sq. ft.

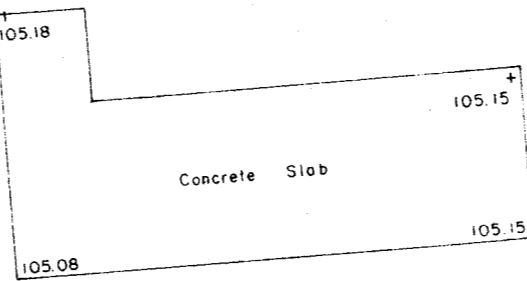

INGRESS - EGRESS EASEMENT
4,016 Sq. ft.
0.092 Acres

BEN P. LUCAS

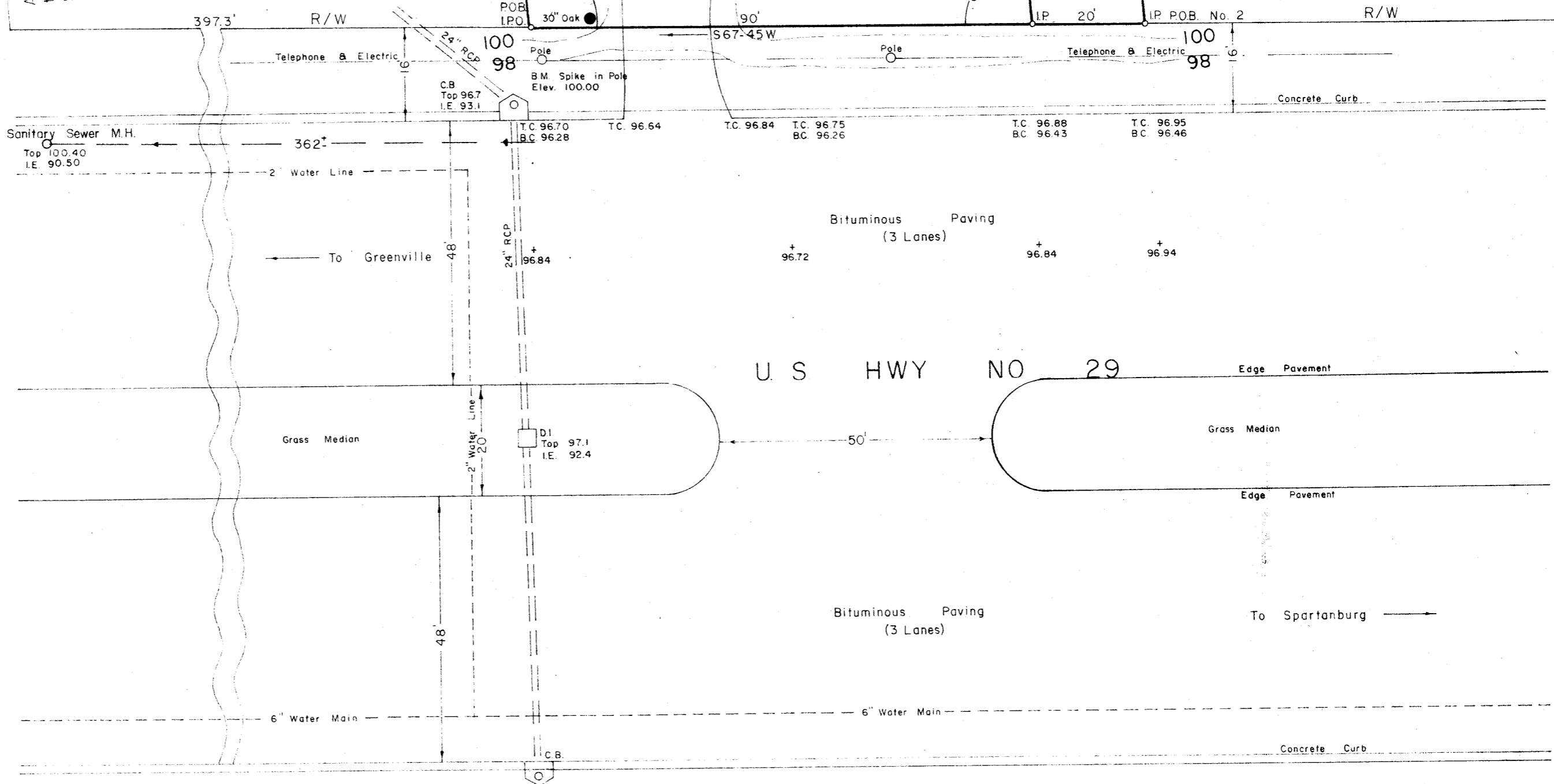

TOPOGRAPHICAL MAP FOR

NATIONAL PRIDE EQUIPMENT, INC.

GREENVILLE COUNTY

GREER, SOUTH CAROLINA

Scale 1" = 20" July, 1978

DALTON & NEVES CO., ENGINEERS

121 MANLY STREET

GREENVILLE, S. C.

✓ 6M-89



4891